

SN-IF05-A

Sensor



SN-IF05-A is the infrared sensor of the SN series. It is widely applied to the automatic switches of public area lighting in the fields of intelligent lighting, smart homes, room control, and security alarm. The extension of work time is adjustable.

Product Model Table

Model	Power	Rated power of load	Installation method	Consumption
SN-IF05-A	220V Power supply	500W (Resistive load)	Surface mounted	20mA@220V

Technical Parameters

No.	Item	Parameter	No.	Item	Parameter
1	Consumption	20mA@220V	7	Storage temperature and humidity	Normal temperature and 0% to 85%RH without condensation
2	Power	220V power supply	8	Material of cover	ABS engineering plastic
3	Rated power	500W (Resistive load)	9	Dimensions	95mm x 34mm
4	Range of detection	110° (Side view) x 360° (Top view)	10	Installation height	1.8m to 3m
5	Switch detection	Electricity signal switch detection, can not connect to light-current system	11	Installation method	Surface mounted
6	Operating temperature	-10 to 40°C			

Installation Description

Please follow the instructions defining the terminal block pins on the equipment cover for wiring. The definition of the terminal block pins is shown in the following table. Please disconnect the circuit to prevent electric shock before wiring. Switch can only be connected to 220V AC appliance, and can only control 220V devices. Check whether the power supply is within the range of the required voltage before supplying the power for the equipment. The power supply shall not exceed this range, otherwise the module may burn. Direct sunlight, moisture, and rain shall be avoided when installing and placing the sensor.

SN-IF04-A Wiring Pin Definition Table

Name	Marking	Description
N	Blue - Naught wire	220V Power Supply
L	Yellow - Live wire	220V Power supply
LOAD	White - Load line	Connect to the load with 500W of rated power (Resistive load)
DI	Switch detection	Electricity signal switch detection, can not connect to light-current system

Dimensions and Wiring Diagram

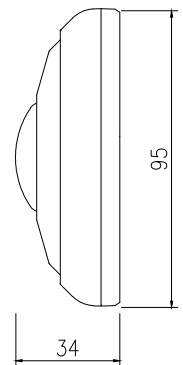
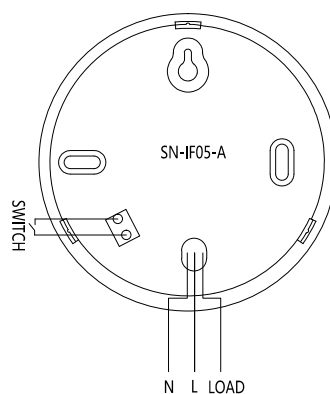
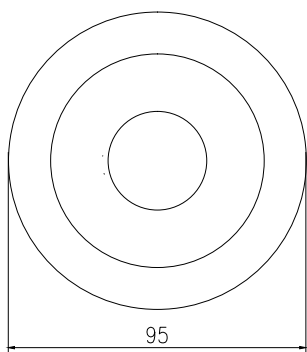

Description of equipment indicator

1. Setting of the Delay Closing Gear

- 0 : 10 second (factory default)
- 1 : 1 minute
- 2 : 3 minutes
- 3 : 5 minutes
- 4 : 10 minutes
- 5 : 15 minutes
- 6 : 20 minutes
- 7 : 30 minutes
- 8 : 40 minutes
- 9 : 60 minutes;

2. DI - Short Press (OFF turns to ON and remains ON for more than 0.1 seconds); If the relay disconnects 0, then the relay immediately closes 1 (press the button to turn on the light when the light turns off); If the relay closes 1, then the relay immediately disconnects 0 (press the button to turn off the light when the light turns on);

3. DI - Long Press (OFF turns to

ON and remains ON for more than 2 seconds. The output locking is off).

4. The timing begins after the closure of the relay and the relay is disconnected after the time of the "delay closing" passes; (the timing will reset during the sensing of people within the timing period and start again after the sensing disappears).